

DRC

PZ23-12000032
08/07/2024

LANDSCAPE NOTES:

- All plant materials to be Fl. #1 or better, as per the latest edition of Fl. Grades & Standards.
- Sod to be St. Augustine Floratam, laid solid.
- All sod & landscape areas to receive 100% coverage from an automatic irrigation system.
- Mulch, planting soils, and fertilizers to be applied as per specs.
- All plant materials shall be true to name & size as per Fl. Grades & Standards. Plants which do not meet specifications will not be accepted.
- Quantities, sizes, and location of plants will be determined by the plan and material schedules. Sizes of plants shall take precedence over container size. Spacing of ground covers will be determined by material schedule. Quantities shown on material schedule are to be used as a guideline. Contractor shall be responsible for the actual quantities shown on the plans. Discrepancies shall be brought to the attention of the Landscape Architect, prior to commencing, in writing.
- No substitutions shall be accepted without Landscape Architects written approval.
- Planting soils shall be clean, sterile, and free of debris, and shall consist of 50% muck & 50% sand. Trees & palms shall be planted with a minimum of 8" on sides & bottom of root balls. Shrubs, plants & ground covers shall be planted with a minimum of 4" on sides & bottom of root balls. Rooted cuttings shall be planted with 4" worked into top 6" of existing soils. Micronutrient fertilizer shall be applied to all plantings, per manufacturers recommendations. In addition, agriform tablets (20-10-5) shall also be applied to all plants 1gal. & above, as per manufacturers recommendations.
- All trees shall be mulched with 3" depth x 3ft. circle. All shrubs & ground cover beds shall receive 1" depth mulch upon completion. Mulch shall be "Flor-mulch", or equal.
- All plants shall be planted at soil levels at which they were previously grown. Shrubs & hedge materials are to be planted 2ft. min. away from walls. Materials with a size greater than overhangs shall be planted so as not to impede the natural growth habit. Sabal palms are to be planted in clean organic sand.
- All materials are to be watered in immediately after planting, so as to remove all air pockets. B&B materials are to be watered once a day for a minimum of 1 week, and thereafter as required. Contractor shall advise the owner of additional watering requirements.
- All trees 8ft., or larger are to be staked, or guyed to provide angle support such that the material stay straight & true thru the guarantee period. Staking & guying shall be done at the option of the contractor, unless specifically requested by the Landscape Architect. However, the contractor shall be responsible for all trees & palms remaining straight & true throughout the guarantee period.
- Sod shall be dense, green, wellrooted, and free of debris, weeds objectional grasses, diseases, or insects. A complete 6-6-6 fertilizer shall be applied at a rate of 10lbs. per 1,000sq.ft. Sod is to be watered to a depth of 3" immediately after installation. Grades to be raked smooth, and all debris removed prior to sod installation.
- All plant materials to be guaranteed for 1 year after completion. Replacement costs to be the responsibility of the contractor.

MATERIAL SCHEDULE

Qty.	Key	Botanical/Common Name	Size
1	Bbtr	Bucida bucerus/Black olive tree	8" calip. relocate
4	Qvtr	Quercus virginiana/Live oak tree, relocate	206", 1812", 1814"
9	Qvt	Quercus virginiana/Live oak tree, relocate	14x7ft. oa. B&B
1	Ict	Ilex cassine/Dahoon holly tree	12x6ft. oa.
17	Sp	Sabal palms	oa. sizes noted, btd
10	Cest	Conocarpus erectus serecius/Silverbtrnwd.	12x6ft. oa. mltl. B&B
3	Cest1	Conocarpus erectus serecius/Silverbtrnwd.	10x5ft. oa. B&B Std.
265	Ces	Conocarpus erectus serecius/Silverbtrnwd.	24" 3gal. #24" oc.
210	TF	Trypocum floridana/Dwf. fakahatchee grass	12-15" 1gal. #18" oc.
225	Ptv	Pittosporum t. varigated/Varigated pitt.	15-18" 3gal. #18" oc.
13	Cet	Conocarpus erectus/Green Btrnwd. tree	12x6ft. oa. B&B
5	Bst	Bursera simaruba/Gumbo limbo tree	" "
50	Fb	Ficus benjamina/Fig	24" 3gal.
140	Ci	Chrysobalanus icaco/Cocoplum	" "

LANDSCAPE REQUIREMENTS:

- Adjacent to public R.O.W.(403ft.) one tree per 30 lin.ft. continuous hedge, 24"ht. Sod: Floratam, as noted Bahia sod, as noted Bahia seed, as noted Rqd.: 13 Provided: 13
- Perimeter landscaping one tree per 40lin.ft. continuous hedge 24" Rqd.: 8 Provided: 9
- Interior landscaping one shade tree per parking island Rqd.: 9 Provided: 10

TREES TO REMAIN:

- 11 Bucida bucerus/Black olive (4-12" calip.)
- Note: All trees to remain shall be barricaded in accordance with arborists standards to the drip line of the tree. No storage of materials, or parking of any vehicles shall occur within these areas.

TREES TO BE RELOCATED:

- 1 Bucida bucerus/Black olive(8"calip.)
- 4 Quercus virginiana/Live oak (6"-14" calip.)

TREES TO BE REMOVED:

All undesirable species, as specified in the code, shall be removed from the construction site.

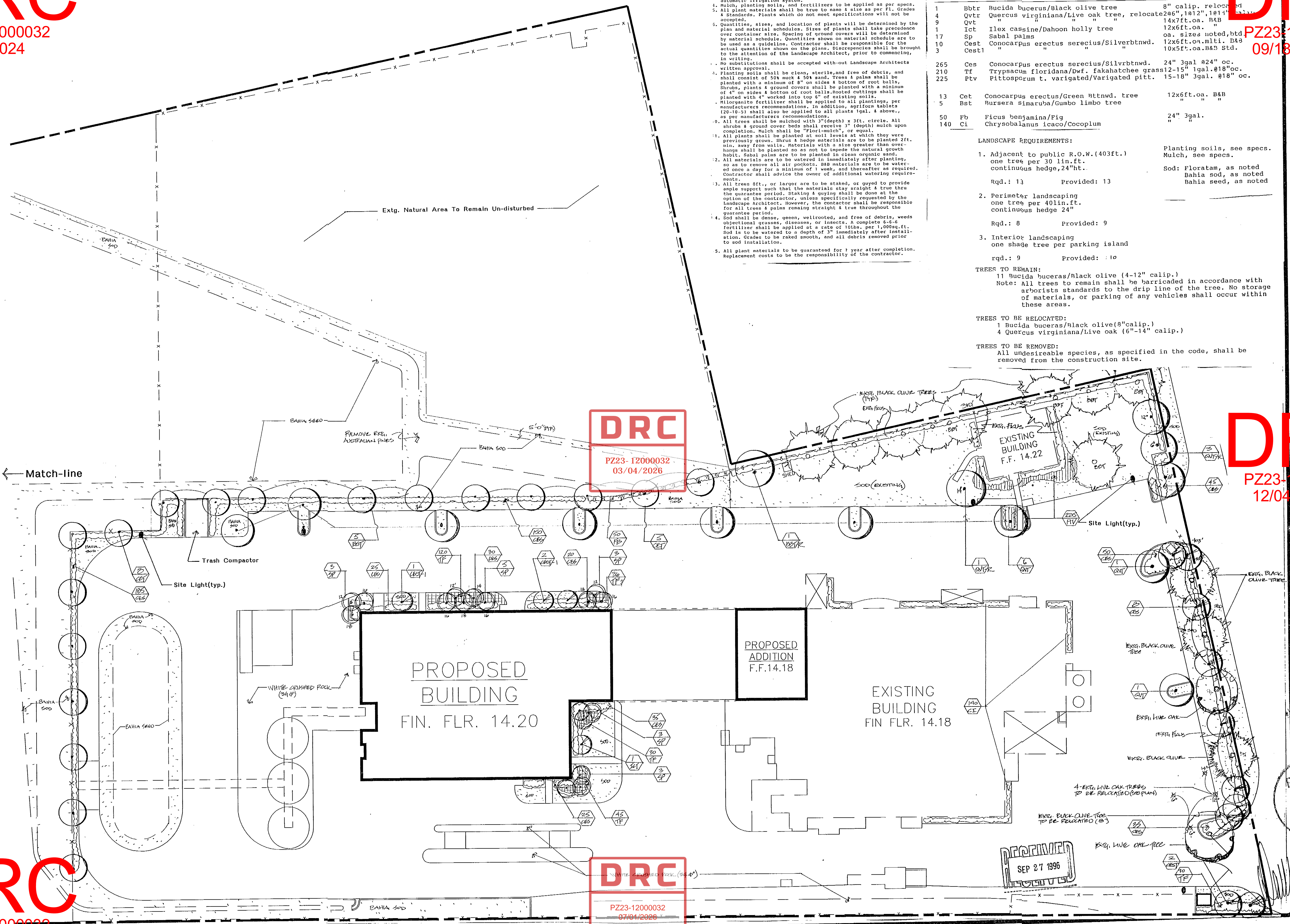

DRC
PZ23-12000032
03/04/2026

DRC
PZ23-12000032
07/01/2026

DRC

PZ23-12000032
09/18/2024

REVISION	BY

Designed By
DANIEL H. CARTER
Landscape Architects
Delray Beach FL.

DRC

PZ23-12000032
02/19/2025

DRC

PZ23-12000032
12/04/2024

Landscape & Irrigation Plans For:
W.R. BONSAI COMPANY
Pompano Beach, Fl.

RECEIVED
SEP 27 1996

DRAWN	CHECKED	DATE	SCALE	JOB NO.	SHEET

201

DRC

PZ23-12000032
04/17/2024